

PURE SINE WAVE INVERTER PI1500 LV Series

300~2000W | 12V,24V | 120V

PI1500 series is a pure sine wave inverter, high frequency machine solution, the product is small size, the solution is reliable and stable, the main function is to invert the DC 12VDC battery or 24VDC battery to AC 120VAC output, mainly used for emergency use Electricity, car inverter, outdoor electricity and other occasions.



- Input Voltage 12V / 24V DC optional
- Output Voltage 120V AC optional
- Portable power for AC products, AC outlets for connecting multiple loads
- High efficiency converts virtually all of the battery's power to AC
- Mounting brackets for convenient installation
- Overload and over temperature shut down
- Low voltage and over voltage alarm/cut off
- Short circuit protection

Solar system connection

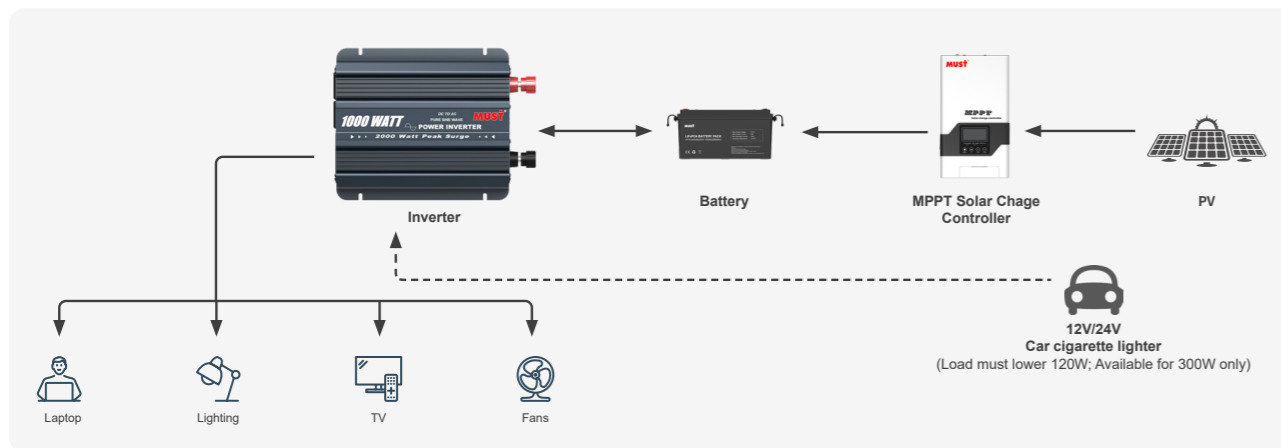

Type



MODEL	PI15-0312 LV	PI15-0324 LV	PI15-0612 LV	PI15-0624 LV	PI15-1012 LV	PI15-1024 LV	PI15-1512 LV	PI15-1524 LV	PI15-2012 LV	PI15-2024 LV
BATTERY DC INPUT										
Input Voltage	12VDC	24VDC	12VDC	24VDC	12VDC	24VDC	12VDC	24VDC	12VDC	24VDC
Low Voltage Protect Delay	2 seconds									
Low Voltage Warning	(PB)	10.5VDC	21.0VDC	10.5VDC	21.0VDC	10.5VDC	21.0VDC	10.5VDC	21.0VDC	10.5VDC
	(LI)	10.5VDC	21.0VDC	11.6VDC	23.2VDC	11.6VDC	23.2VDC	11.6VDC	23.2VDC	11.6VDC
Low Voltage Protect	(PB)	11.5VDC	23.0VDC	11.5VDC	23.0VDC	11.5VDC	23.0VDC	11.5VDC	23.0VDC	11.5VDC
	(LI)	11.5VDC	23.0VDC	12.0VDC	24.0VDC	12.0VDC	24.0VDC	12.0VDC	24.0VDC	12.0VDC
Low Voltage Restoring	(PB)	12.5VDC	25.0VDC	12.5VDC	25.0VDC	12.5VDC	25.0VDC	12.5VDC	23.0VDC	12.5VDC
	(LI)	12.5VDC	25.0VDC	12.8VDC	25.6VDC	12.8VDC	25.6VDC	12.8VDC	25.6VDC	12.8VDC
Over Voltage Protect	(PB)	14.7VDC	29.4VDC	14.7VDC	29.4VDC	14.7VDC	29.4VDC	14.7VDC	29.4VDC	14.7VDC
	(LI)	14.7VDC	29.4VDC	14.5VDC	29.0VDC	14.5VDC	29.0VDC	14.5VDC	29.0VDC	14.5VDC
Over Voltage Restoring	(PB)	15.0VDC	30.0VDC	15.0VDC	30.0VDC	15.0VDC	30.0VDC	15.0VDC	30.0VDC	15.0VDC
	(LI)	15.0VDC	30.0VDC	14.8VDC	29.6VDC	14.8VDC	29.6VDC	14.8VDC	29.6VDC	14.8VDC

Parameters: (PB) Lead-acid Battery / (LI) 4 series (12V), 8 series (24V) LiFePO4 Lithium Battery Pack

INVERTER AC OUTPUT					
Default Power	300W	600W	1000W	1500W	2000W
Peak Power	600W	1200W	2000W	3000W	4000W
Output AC Voltage	120V	120V	120V	120V	120V
Output AC Frequency	60Hz	60Hz	60Hz	60Hz	60Hz
Output Wave	Pure Sine Wave				
Output Wave THD	< 3%				

PROTECTION	
Battery Input Protection	Low Voltage Protection, Over Voltage Protection, Reverse Protection
Inverter Output Protection	Output Overload, Short-Circuit, Over Temperature Protection

DISPLAY	
LED Display	Red: Error ; Green: System OK
LED Digital Display	/ Display Battery Voltage, Output Power, Output Voltage, Error Numbers

DC OUTPUT	
USB	USB-A type (5V1A)

EFFICIENCY	
Peak Conversion efficiency	91% 91% 90% 88% 90% 88% 90%

MECHANICAL SPECIFICATIONS				
Machine Dimension (W*H*D)(mm)	205*125*61	242*158*81	291*220*83	380.8*248*90
Package Dimension (W*H*D)(mm)	228*102*176	268*140*205	330*147*267	420*150*300
N.W(kg)	1	1.7	2.6	4.5
G.W(kg)	9.3 (8pcs)	15 (8pcs)	23 (8pcs)	19 (4pcs)

OTHER	
Protection Degree	IP20 IP20 IP20 IP20 IP20 IP20 IP20 IP20 IP20 IP20
Working Environment	Indoor Fan cooling
Environmental temperature	0~45°C
Ambient humidity	20%-90%, No condensation
Altitude	≤3000m
Standard Warranty	2 year

CERTIFICATION & STANDARDS	
CE-EMC+LVD (EN6100-6-3, EN6100-6-1+EN IEC62109-1, EN IEC62109-2)	
CE-LVD(EN 62477-1/A11)	

*The technical specifications of this document are subject to change without any notice